

STATE OF SOUTH CAROLINA  
COUNTY OF YORK

PETITION FOR ANNEXATION TO THE CITY OF ROCK HILL  
OF HILLTOP ROAD AND ROSEWOOD DRIVE AREA  
LYING ADJACENT TO THE CITY LIMITS  
OF THE CITY OF ROCK HILL, S. C.  
AS SHOWN ON MAP DATED JUNE 12, 2009

TO: The Governing Body of the City of Rock Hill, S. C.

Your Petitioners, the undersigned freeholders, respectfully show and submit:

(1) That each of your Petitioners is a freeholder owning real estate in York County, S. C., lying in an area adjacent to the City of Rock Hill, hereby proposed for annexation to the City of Rock Hill.

(2) That the area proposed to be annexed is particularly shown upon a map entitled "Hilltop Road and Rosewood Drive Area Annexation To The City Of Rock Hill", prepared by James Kiley, dated June 12, 2009, showing the area proposed for annexation, the affected annexation area shown thereby being also described in a narrative form upon a sheet attached hereto entitled "Description of Hilltop Road and Rosewood Drive Area Proposed For Annexation To The City Of Rock Hill, S.C."; the aforesaid map and description being hereby incorporated herein and made a part hereof by reference.

(3) That each of the undersigned hereby petitions the Governing Body of the City of Rock Hill to determine the number of signatories to this Petition, and to arrange for the adoption of an annexing ordinance as permitted by §5-3-150, Code of Laws of South Carolina (1976, as amended), if the Petition has been signed (i) by at least 75% of the freeholders owning at least 75% of the assessed valuation of the real property in the area requesting annexation, or (ii) by all of the freeholders owning property in said area.

(4) That the undersigned Petitioners hereby agree that their respective properties shall be subject to all City property taxes effective from the 1st day of January next following date of final passage of annexation ordinance, and they hereby request that all

available City services be commenced in said area effective at the earliest practicable time following completion of annexation.

(5) When it becomes practicable for City to provide services, the undersigned Petitioners understand that they will be subject to all applicable charges for such services, including charges imposed to initiate service, as fixed by City Ordinance at the time of service.

(6) That incident to annexation of the aforementioned area, your Petitioners hereby request and agree that the area to be annexed shall be classified for zoning purposes as Single Family Residential-5 (SF-5) as specifically shown on map attached hereto.

(7) That also incident to annexation of the aforementioned area, your Petitioners hereby request and agree that the whole of the area to be annexed shall be added to and included in Ward 2 of the 2009 Ward Plan of the City of Rock Hill, as created and established pursuant to §14-10 of the Code of the City of Rock Hill, to which Ward said annexation area is adjacent.

(8) That for the information of City Council there is attached hereto a list of the freeholders owning property within the territory proposed to be annexed and/or a list of freeholders who reside within the territory proposed to be annexed, as shown by the County tax records and voter registration records, certified as true and correct by the appropriate authority.

(9) That the within written Petition may be submitted in more than one counterpart, all of which shall nevertheless be and constitute one and only one Petition, for the purposes sought to be accomplished thereby.

Rock Hill, South Carolina

Respectfully submitted,

7-30

, 2009

Signature

Address

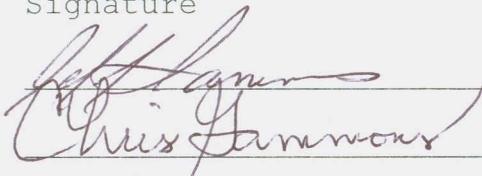
  
Chris Jammons

1936 Hilltop Rd  
1936 Hilltop Rd.

Rock Hill, South Carolina

Respectfully submitted,

Aug. 3, 2009

Signature

Robert Lee

Address

1941 Hilltop RD

Rock Hill SC, 29732

Rock Hill, South Carolina

Respectfully submitted,

7/28/2009, 2009

Signature

Address

Jenny Valeri

1942 HILLTOP Rd.

Natasha Mag.

"

Rock Hill, South Carolina

Respectfully submitted,

Aug 3, 2009

Signature

*Vanessa R. Jackson*

Address

1935 Hilltop Rd.  
Rock Hill SC 29732

DESCRIPTION OF HILLTOP ROAD AND ROSEWOOD DRIVE AREA  
PROPOSED FOR ANNEXATION TO THE  
CITY OF ROCK HILL, S.C.

All that certain piece, parcel or tract of land, lying, being and situate generally in an unincorporated area in the northern portion of the greater Rock Hill area, and specifically lying adjacent to the south and east of the existing corporate limits of the City of Rock Hill, in Ebenezer Township, York County, South Carolina, containing 1.56 acres, more or less; lying in the vicinity of Hilltop Road and Rosewood Drive, all as shown and delineated, and bounded as shown, upon a plat entitled "Hilltop Road and Rosewood Drive Area Annexation To The City Of Rock Hill", by James Kiley, dated June 12, 2009, which is attached hereto and made a part hereof for a more particular and detailed description.



**ROCK HILL**  
SOUTH CAROLINA  
**ANNEXATION MAP**

Hilltop Rd and  
Rosewood Dr Area

**ANNEXATION TO THE  
CITY OF ROCK HILL**



ZONING: SF-5  
WARD: WARD 2



THIS MAP WAS COMPILED FROM PLATS AND  
OTHER AVAILABLE INFORMATION.  
NO ACTUAL FIELD SURVEY WAS PERFORMED.

DATE: 6-12-2009  
JOB ADMINISTRATOR: [Signature]

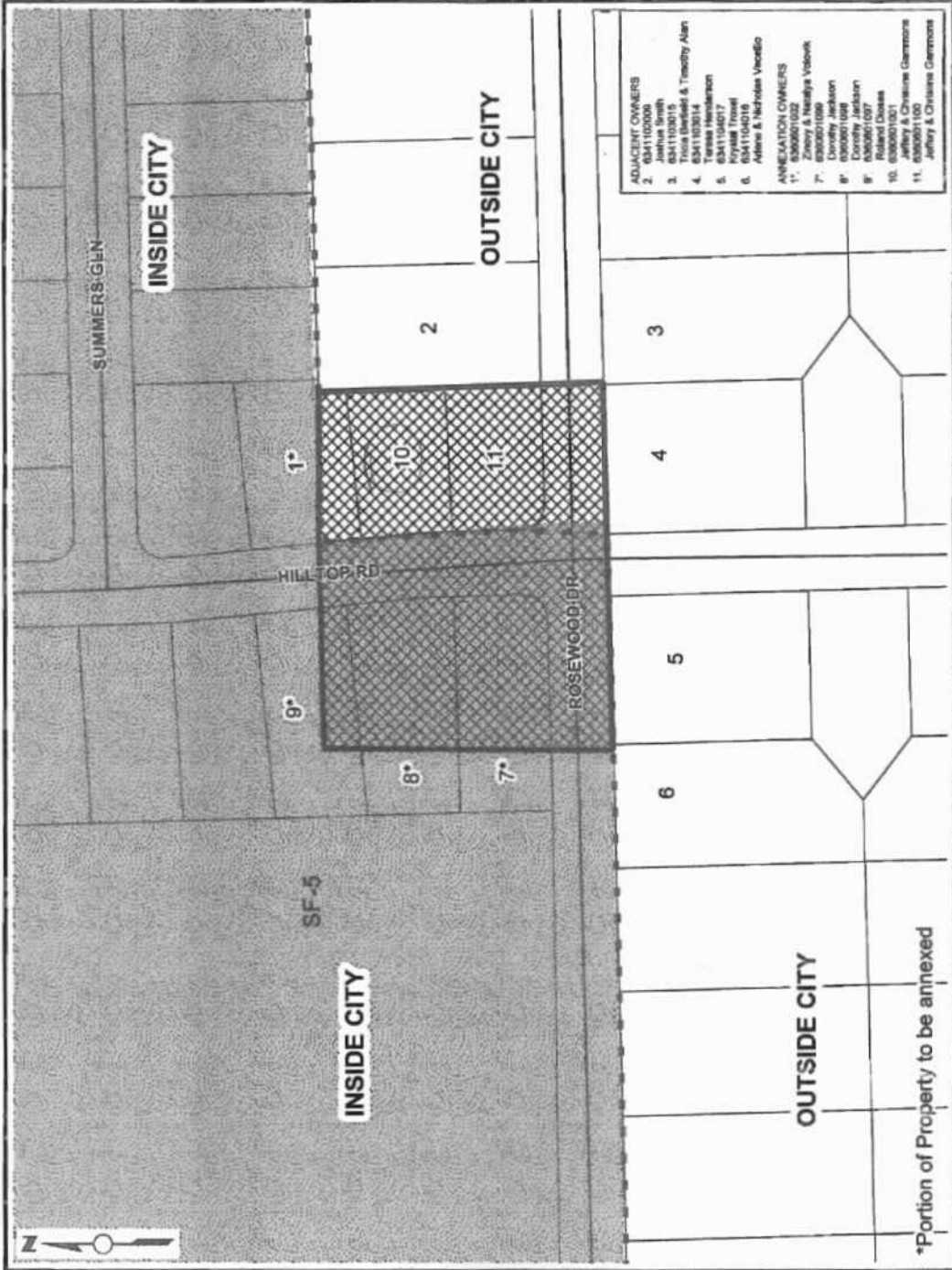

ADJACENT OWNERS	
2.	6341102000 Justin Smith
3.	6341103015 Erica Daniels & Timothy Alan
4.	6341104016 Teresa Henderson
5.	6341104017 Kyrill Trussell
6.	6341104018 Arlene & Nicholas Vaccaro
ANNEXATION OWNERS	
1.	6309010022 Zenny & Neelya Volokh
7.	6309010099 Dorethy Jackson
8.	6309010098 Dorethy Jackson
9.	6309010097 Roland Dosses
10.	6309010001 Jeffery & Christine Gammons
11.	6309011000 Jeffery & Christine Gammons

\*Portion of Property to be annexed