

STATE OF SOUTH CAROLINA  
COUNTY OF YORK

PETITION FOR ANNEXATION TO THE CITY OF ROCK HILL  
OF MORGAN'S MEADOWS AREA IV  
LYING ADJACENT TO THE CITY LIMITS  
OF THE CITY OF ROCK HILL, S. C.  
AS SHOWN ON MAP DATED AUGUST 13, 2009

TO: The Governing Body of the City of Rock Hill, S. C.

Your Petitioners, the undersigned freeholders, respectfully show and submit:

(1) That each of your Petitioners is a freeholder owning real estate in York County, S. C., lying in an area adjacent to the City of Rock Hill, hereby proposed for annexation to the City of Rock Hill.

(2) That the area proposed to be annexed is particularly shown upon a map entitled "Morgan's Meadows Area IV Annexation To The City Of Rock Hill", prepared by James Kiley, dated August 13, 2009, showing the area proposed for annexation, the affected annexation area shown thereby being also described in a narrative form upon a sheet attached hereto entitled "Description of Morgan's Meadows Area IV Proposed For Annexation To The City Of Rock Hill, S.C."; the aforesaid map and description being hereby incorporated herein and made a part hereof by reference.

(3) That each of the undersigned hereby petitions the Governing Body of the City of Rock Hill to determine the number of signatories to this Petition, and to arrange for the adoption of an annexing ordinance as permitted by §5-3-150, Code of Laws of South Carolina (1976, as amended), if the Petition has been signed (i) by at least 75% of the freeholders owning at least 75% of the assessed valuation of the real property in the area requesting annexation, or (ii) by all of the freeholders owning property in said area.

(4) That the undersigned Petitioners hereby agree that their respective properties shall be subject to all City property taxes effective from the 1st day of January next following date of final passage of annexation ordinance, and they hereby request that all available City services be commenced in said area effective at the earliest practicable time following completion of annexation.

(5) When it becomes practicable for City to provide services, the undersigned Petitioners understand that they will be subject to all applicable charges for such services, including charges imposed to initiate service, as fixed by City Ordinance at the time of service.

(6) That incident to annexation of the aforementioned area, your Petitioners hereby request and agree that the area to be annexed shall be classified for zoning purposes as Single Family Residential-5 (SF-5) as specifically shown on map attached hereto.

(7) That also incident to annexation of the aforementioned area, your Petitioners hereby request and agree that the whole of the area to be annexed shall be added to and included in Ward 1 of the 2009 Ward Plan of the City of Rock Hill, as created and established pursuant to §14-10 of the Code of the City of Rock Hill, to which Ward said annexation area is adjacent.

(8) That for the information of City Council there is attached hereto a list of the freeholders owning property within the territory proposed to be annexed and/or a list of freeholders who reside within the territory proposed to be annexed, as shown by the County tax records and voter registration records, certified as true and correct by the appropriate authority.

(9) That the within written Petition may be submitted in more than one counterpart, all of which shall nevertheless be and constitute one and only one Petition, for the purposes sought to be accomplished thereby.

Rock Hill, South Carolina

Respectfully submitted,

August 19, 2009, 2009

(Signature)

(Address)

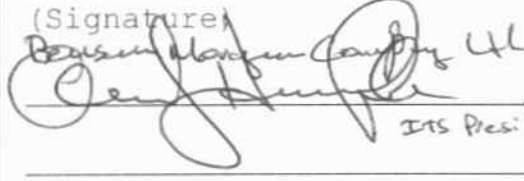
by:    
 ITS President

3108 LAKE WYLYE DR  
Rock Hill, SC 29732

DESCRIPTION OF MORGAN'S MEADOWS AREA IV  
PROPOSED FOR ANNEXATION TO THE  
CITY OF ROCK HILL, S.C.

All that certain piece, parcel or tract of land, lying, being and situate generally in an unincorporated area in the western portion of the greater Rock Hill area, and specifically lying adjacent to the north of the existing corporate limits of the City of Rock Hill, in Catawba Township, York County, South Carolina, containing 0.41 acre, more or less; lying in the vicinity of Coatsworth Lane, all as shown and delineated, and bounded as shown, upon a plat entitled "Morgan's Meadows Area IV Annexation To The City Of Rock Hill", by James Kiley, dated August 13, 2009, which is attached hereto and made a part hereof for a more particular and detailed description.



**ROCK HILL**  
SOUTH CAROLINA  
ANNEXATION MAP

Morgan's Meadows  
Area IV

ANNEXATION TO THE  
CITY OF ROCK HILL

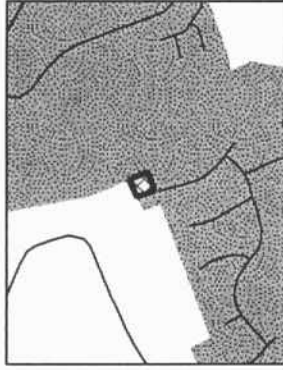

ZONING: SF-5  
WARD: WARD 1  
ACREAGE: .41

- City Limits
- Zoning Boundary
- Subject Property

0 180 360  
Feet

THIS MAP WAS COMPILED FROM PLATS AND  
OTHER AVAILABLE INFORMATION.  
NO ACTUAL FIELD SURVEY WAS PERFORMED.

8-15-09  
DATE

GIS ADMINISTRATOR

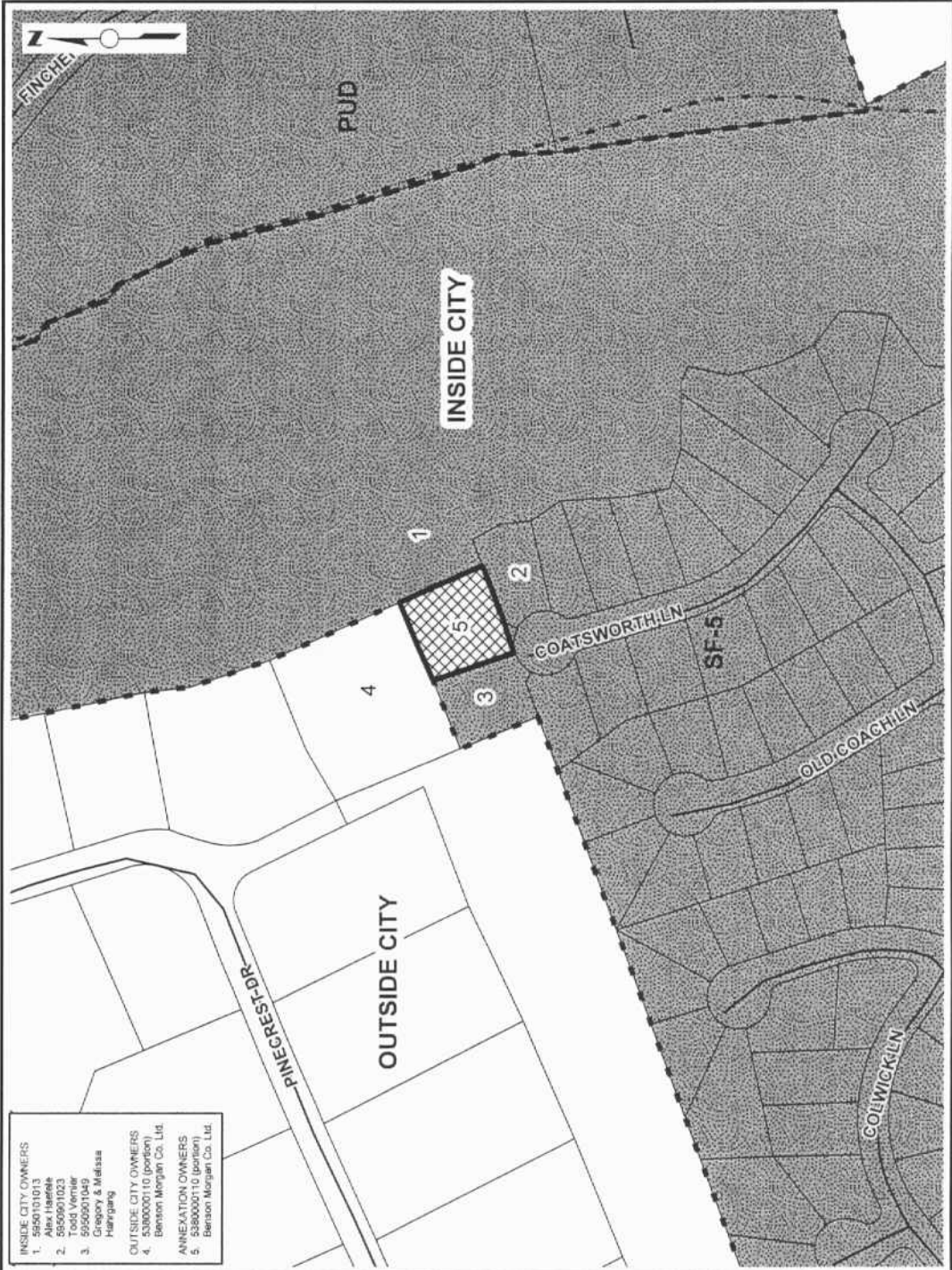

- INSIDE CITY OWNERS**
1. 595010103  
Arlene  
6852001023
  2. Todd Verner
  3. 595001049  
Gregory & Melissa  
Hanggang
- OUTSIDE CITY OWNERS**
4. 538000110 (portion)  
Benson Morgan Co. Ltd.
- ANNEXATION OWNERS**
5. 538000110 (portion)  
Benson Morgan Co. Ltd.