

DATE
10-3, 11
REVIEWED BY
PREPARED BY
CITY ATTORNEYS OFFICE

DOCU-
MENT

ATTACH-
MENTS

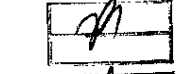
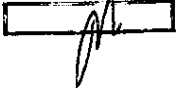

AN ORDINANCE TO AMEND CHAPTER 7, ANNEXATIONS, OF THE
CODE OF THE CITY OF ROCK HILL, SO AS TO PROVIDE FOR THE
ANNEXATION, ZONING AND WARD DESIGNATION OF
CELANESE/RIVERVIEW ROAD AREA LYING
ADJACENT TO THE CITY LIMITS OF THE
CITY OF ROCK HILL, S. C.

BE IT ORDAINED by the Governing Body of the City of Rock Hill,
in Council assembled:

Section 1. That Chapter 7, Annexations, of the Code of the City of
Rock Hill, be and the same is hereby amended as follows:

(A) By adding a new section to said Chapter as a part of
Chapter 7 - Annexations, as follows:

"Sec. 7-315 Celanese/Riverview Road Area Annexation.

The area lying adjacent to the City Limits
of the City of Rock Hill, identified and
described in a petition dated October __, 2011,
entitled "Petition For Annexation To The City
Of Rock Hill Of Celanese/Riverview Road Area
Lying Adjacent To The City Limits Of The City
Of Rock Hill, S.C., as Shown On Map Dated
September 29, 2011", and filed with the
Municipal Clerk, has been duly annexed to and
is a part of the City of Rock Hill, S.C."

Section 2. That the Celanese/Riverview Road Area is being annexed
responsive to a petition signed by at least 75% of all the
freeholders owning at least 75% of the assessed valuation of the
real property in said area, which Petition is duly approved by City
Council under and pursuant to the authority of Section 5-3-150, Code
of Laws of South Carolina for 1976.

Section 3. That all available City services shall be commenced in said area as soon as practicable, as and where needed and required, and same shall become subject to all City property taxes effective from the 1st day of January next following date of final passage of annexation ordinance.

Section 4. That, in accordance with Section 1-700 of the Zoning Ordinance of the City of Rock Hill, and incident to and as a part of the annexation proceedings, said annexation area is hereby classified for zoning purposes as Limited Commercial (LC) as shown on map entitled "Celanese/Riverview Road Area Annexation To The City Of Rock Hill", dated September 29, 2011, prepared by Shawn Carson.

Section 5. That, in accordance with Section 14-10 of the Code of the City of Rock Hill, and incident to and as a part of these annexation proceedings, said annexation area is hereby added to the Ward System Map identified in said section and made a part of Ward No. 6 of the 2011 Ward Plan.

Section 6. That all ordinances or parts of ordinances inconsistent with this Ordinance are hereby repealed to the extent of such inconsistency.

Section 7. That this Ordinance shall be and become finally binding immediately after same shall have received first and second readings, given in the manner required by law.

DONE AND RATIFIED in Council assembled on this the ____ day
of _____, 2011.

A. Douglas Echols, Jr., Mayor

Susie B. Hinton, Mayor Pro Tempore

John A. Black, III, Councilmember

Kathy S. Pender, Councilmember

James C. Reno, Jr., Councilmember

Osbey Roddey, Councilmember

Kevin H. Sutton, Councilmember

ATTEST:

Anne H. Poag
Municipal Clerk



ROCK HILL
SOUTH CAROLINA
ANNEXATION MAP
Celanese/Riverview
Road Area

**ANNEXATION TO THE
CITY OF ROCK HILL**

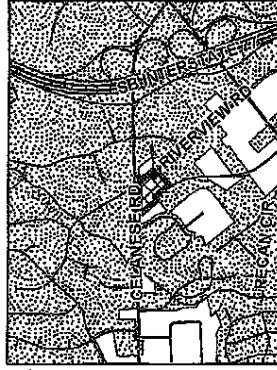

ZONING: LC
WARD: WARD 6
ACREAGE: 3.39



THIS MAP WAS COMPILED FROM PLATS AND
OTHER AVAILABLE INFORMATION.
NO ACTUAL FIELD SURVEY WAS PERFORMED.

DATE: 4/29/15
GIS ADMINISTRATOR: [Signature]

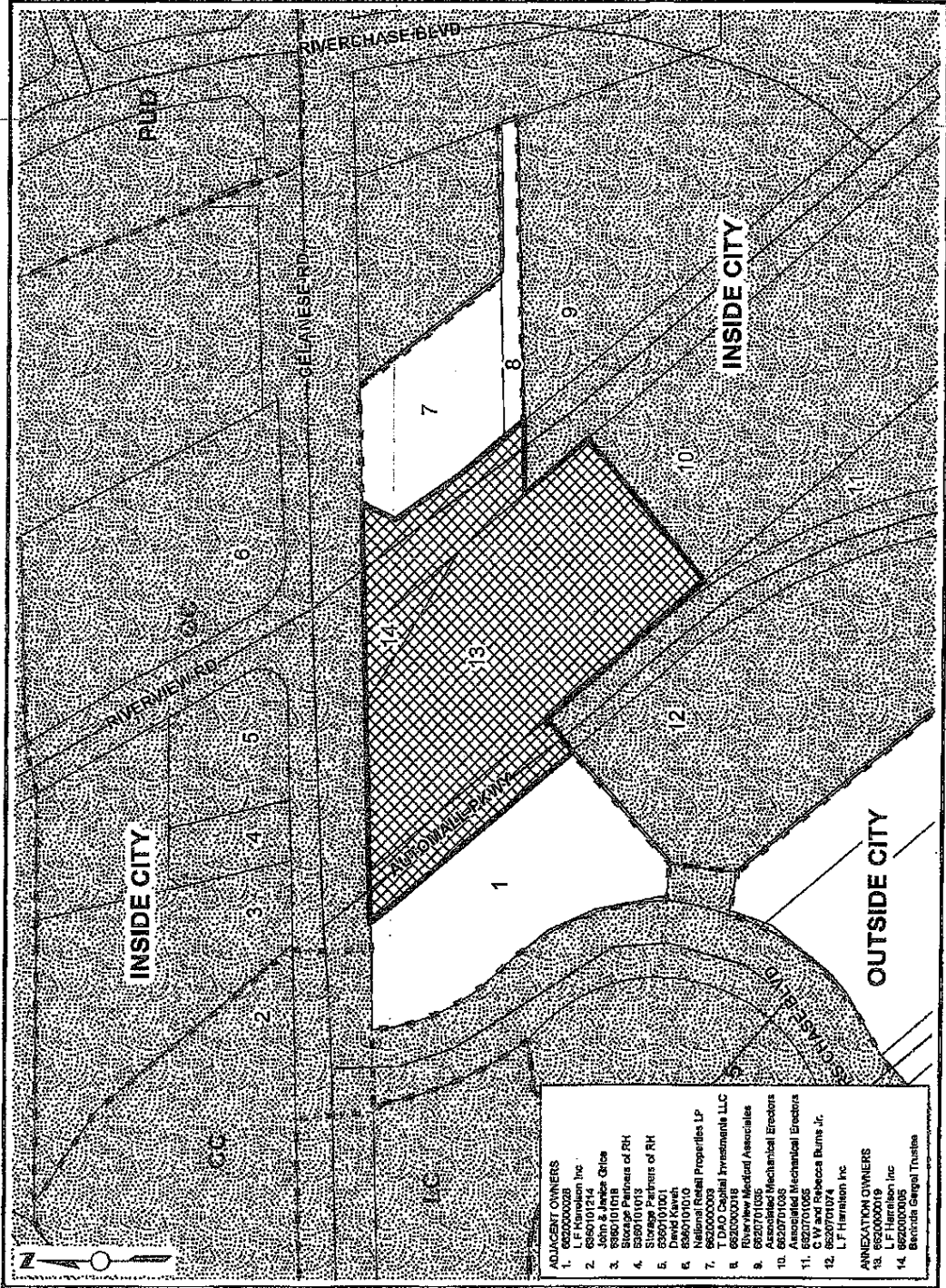

ADJACENT OWNERS	
1.	662000029 L F Harrison Inc
2.	656701214 Jim & Jenie Grice
3.	Storage Partners of RH
4.	626010193 Storage Partners of RH
5.	656701001 Storage Partners of RH
6.	626010193 National Retail Properties LP
7.	662000009 T DAO Capital Investments LLC
8.	662000018 Associated Mechanical Erectors
9.	626010193 Associated Mechanical Erectors
10.	662070103 Associated Mechanical Erectors
11.	626701056 L F Harrison Inc
12.	662070104 L F Harrison Inc
ANNEXATION OWNERS	
13.	662000019 L F Harrison Inc
14.	662000005 Bevin's General Trustee