

DATE 9-19, 11

DOCU-
MENT

ATTACH-
MENTS

REVIEWED BY
PREPARED BY

[Redacted]

[Redacted]

CITY ATTORNEYS OFFICE

AN ORDINANCE TO AMEND CHAPTER 7, ANNEXATIONS, OF THE CODE OF THE CITY OF ROCK HILL, SO AS TO PROVIDE FOR THE ANNEXATION, ZONING AND WARD DESIGNATION OF AUTOMALL PARKWAY AREA III LYING ADJACENT TO THE CITY LIMITS OF THE CITY OF ROCK HILL, S. C.

BE IT ORDAINED by the Governing Body of the City of Rock Hill, in Council assembled:

Section 1. That Chapter 7, Annexations, of the Code of the City of Rock Hill, be and the same is hereby amended as follows:

(A) By adding a new section to said Chapter as a part of Chapter 7 - Annexations, as follows:

"Sec. 7-314 Automall Parkway Area III Annexation.

The area lying adjacent to the City Limits of the City of Rock Hill, identified and described in a petition dated June 21, 2011, entitled "Petition For Annexation To The City Of Rock Hill Of Automall Parkway Area III Lying Adjacent To The City Limits Of The City Of Rock Hill, S.C., as Shown On Map Dated June 20, 2011", and filed with the Municipal Clerk, has been duly annexed to and is a part of the City of Rock Hill, S.C."

Section 2. That the Automall Parkway Area III is being annexed responsive to a petition signed by at least 75% of all the freeholders owning at least 75% of the assessed valuation of the real property in said area, which Petition is duly approved by City Council under and pursuant to the authority of Section 5-3-150, Code of Laws of South Carolina for 1976.

Section 3. That all available City services shall be commenced in said area as soon as practicable, as and where needed and required, and same shall become subject to all City property taxes effective from the 1st day of January next following date of final passage of annexation ordinance.

Section 4. That, in accordance with Section 1-700 of the Zoning Ordinance of the City of Rock Hill, and incident to and as a part of the annexation proceedings, said annexation area is hereby classified for zoning purposes as Community Commercial (CC) as shown on map entitled "Automall Parkway Area III Annexation To The City Of Rock Hill", dated June 20, 2011, prepared by James Kiley.

Section 5. That, in accordance with Section 14-10 of the Code of the City of Rock Hill, and incident to and as a part of these annexation proceedings, said annexation area is hereby added to the Ward System Map identified in said section and made a part of Ward No. 6 of the 2011 Ward Plan.

Section 6. That all ordinances or parts of ordinances inconsistent with this Ordinance are hereby repealed to the extent of such inconsistency.

Section 7. That this Ordinance shall be and become finally binding immediately after same shall have received first and second readings, given in the manner required by law.

DONE AND RATIFIED in Council assembled on this the ____ day
of _____, 2011.

A. Douglas Echols, Jr., Mayor

Susie B. Hinton, Mayor Pro Tempore

John A. Black, III, Councilmember

Kathy S. Pender, Councilmember

James C. Reno, Jr., Councilmember

Osbey Roddey, Councilmember

Kevin H. Sutton, Councilmember

ATTEST:

Anne H. Poag
Municipal Clerk



ROCK HILL
SOUTH CAROLINA

ANNEXATION MAP
Automall Parkway
Area III

ANNEXATION TO THE
CITY OF ROCK HILL

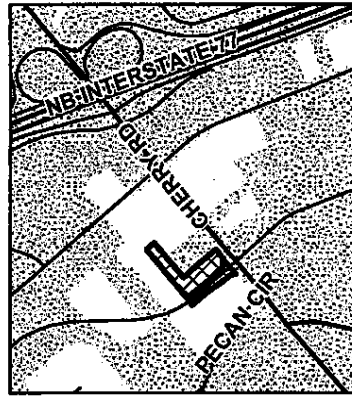

ZONING: CC
WARD: 6
ACREAGE: 2.74 [2.05 + 0.69 (R-O-W)]

- Subject Properties
- Zoning District
- Boundaries
- City Limits



THIS MAP WAS COMPILED FROM PLATS AND OTHER AVAILABLE INFORMATION. NO ACTUAL FIELD SURVEY WAS PERFORMED.

[Signature] 6-20-2011
DATE
GIS ADMINISTRATOR

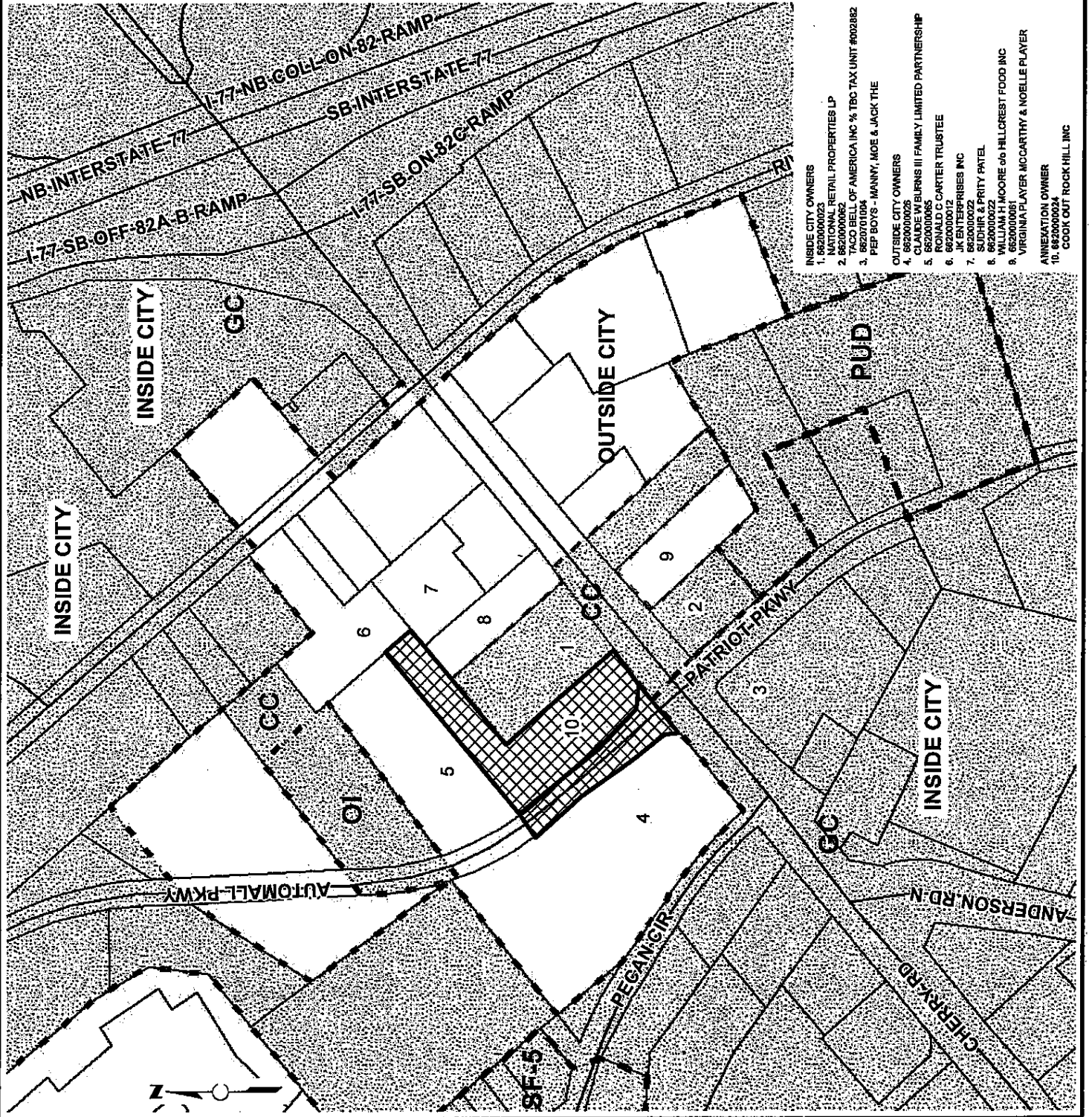

- INSIDE CITY OWNERS**
1. 6620000023 NATIONAL RETAIL PROPERTIES LP
 2. 6620000062 TACO BELL OF AMERICA INC % TBC TAX UNIT #002882
 3. 6620010004 PEP BOYS - MANNY, MOE & JACK THE
- OUTSIDE CITY OWNERS**
4. CLAUDE WILBURN III FAMILY LIMITED PARTNERSHIP
 5. 6620000085 RONALD C CARTER TRUSTEE
 6. 6620000012 JK ENTERPRISES INC
 7. 6620000022 SUDHIR & PRITY PATEL
 8. 6620000022 WILLIAM MICHAEL HILLGREST FOOD INC
 9. 6620000081 VIRGINIA PLAYER MCCARTHY & NOELLE PLAYER
- ANNEXATION OWNER**
10. 6620000024 COOK OUT ROCK HILL INC